

TOWARD CASTLE

Early castle of the Clan Chiefs. Built in the late 1400's by John VII, and originally of four stories. Visited by Queen Mary in July 1563. Located about 7 miles south of Dunoon. Note the many small stones in the wall construction. It was destroyed by the Campbells in 1646, resulting in the treacherous slaughter of 200 defenders. The Lamont Memorial in Dunoon commemorates that event

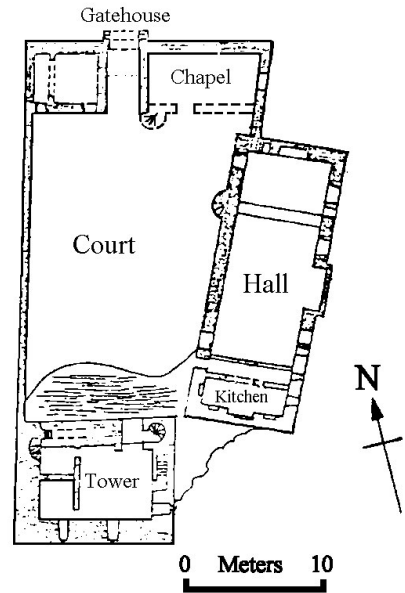

View from the East



Plan of Toward Castle



View of the tower from the South



Entrance gate in the North wall